

## CONSTRUCTION BLOCK WITH SHACKLE

## 2 SHEAVES

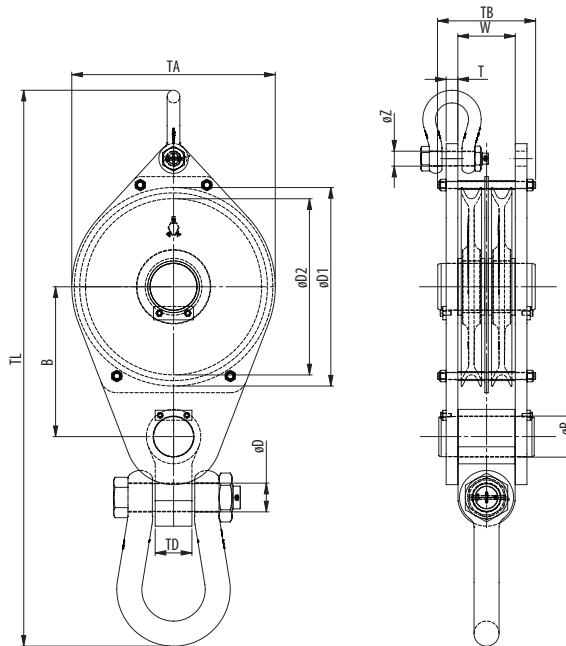

Model No.	WLL (Mtons)	For wire ød (mm)	Dimensions (mm)												Weight (kg)
			øD1	øD2	B	øD	øP	TD	øZ	T	TA	TB	TL	W	
CB 260.16.2.27,5	27,5	13-16	300	260	258	53	60	45	28	20	310	190	948	106	88
CB 320.19.2.41	41	16-19	365	320	297	60	70	60	31	25	375	214	1078	120	143
CB 355.22.2.55	55	19-22	410	355	339	73	100	80	41	30	420	252	1328	148	236
CB 400.26.2.68	68	19-26	460	400	368	73	100	80	41	30	470	260	1388	148	285
CB 450.28.2.82	82	22-28	515	450	409	86	120	110	45	35	530	294	1586	172	426
CB 528.32.2.100	100	22-32	595	528	449	86	120	110	45	35	610	294	1666	172	513
CB 575.36.2.114	114	26-36	650	575	494	98	140	120	53	40	670	339	1929	198	746
CB 630.38.2.127	127	26-38	710	630	524	98	140	120	53	40	730	339	1989	198	789

Minimum Ultimate Strength = 4 x WLL

- Standard delivered with bronze bearing
- The dimensions in this table are indicative only. A drawing will always be submitted prior production and will be the leading document when discussing dimensions.
- Blocks shown here are standard models; inquiries for custom versions are welcome.
- Refer to wire rope manufacturers D/d ratio guideline.



**SEE OUR WARNING & SAFETY INFORMATION**

